

HOME INFO

Unit Address:	511 South Pinehurst Ave Salisbury (Wicomico) MD 21801
Size/Bed/Bath:	1,220, 4 bedroom, 1.5 bathroom (APPROVED FOR UP TO 4 PEOPLE)
Rent:	\$2,100/month
Security Deposit:	\$2,100
Availability Date:	6/15/2023

UTILITIES

Electric:	TBD (new central HVAC system will cause electric bills to vary from past bills) Billed directly by Delmarva Power (1-800-375-7117)
Gas:	TBD (only gas appliance is hot water heater) Billed directly by Chesapeake Utilities (1-800-427-2883)
Water:	Approximately \$120/quarter average Billed by Landlord
Trash:	Trash pickup is included
Cable:	Billed directly by Comcast Cable (1-800-934-6489)
Telephone:	Billed directly by Verizon (1-800-837-4966)
Internet:	Billed directly by Comcast Cable (1-800-934-6489)

PARKING & OTHER TERMS

Off street parking is included in the rear of the property. Lawn service is included.

PHOTOS



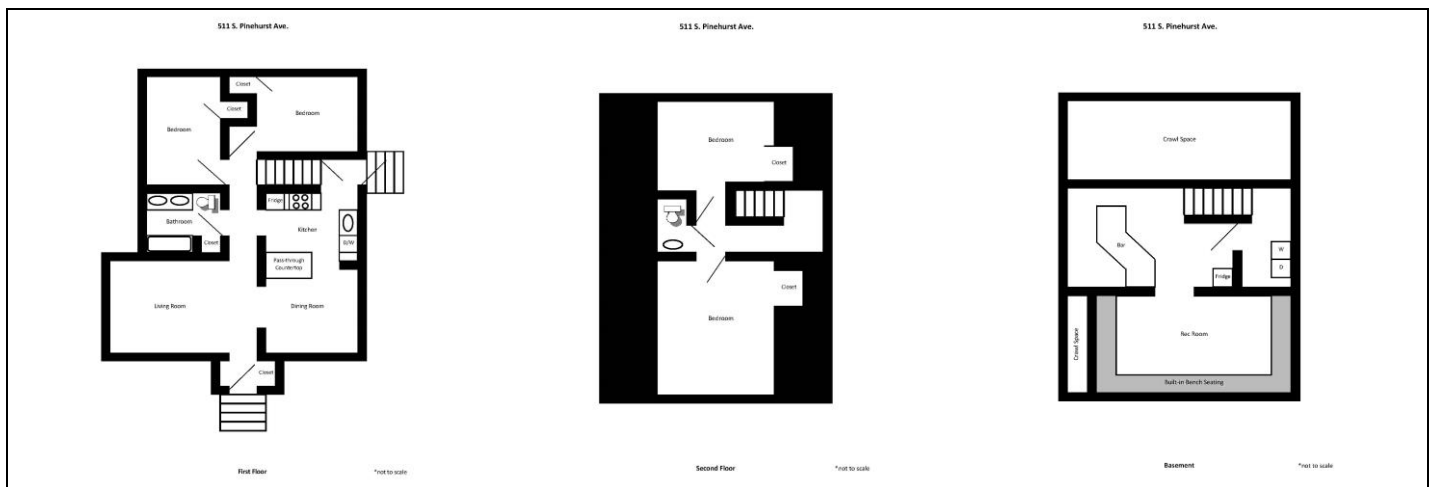

APPLICATION PROCESS

All applications are processed on a first-come-first-serve basis (the application will only be considered once all the application, application fee and any other documents are provided). Once an application is approved, the applicant shall have 24 hours to sign the lease and provide the full security deposit. If these actions are not completed within 24 hours, the next application will be processed.

To process the application we must have:

- The completed application (linked below) with ALL fields filled out and submitted online at www.cclofts.com/application **(there should be one application, with a guarantor included, per resident)**
- The NON-REFUNDABLE application fee (\$35 per listed applicant – tenant + guarantor = \$70) payable online by credit card (the second step of the application will prompt you for payment information)
- Any other required documentation as requested based on unique cases (such as grantor information, proof of alternate income, etc.)

The approval process evaluates the following criteria:

- Income & employment verification
- Credit history
- Criminal history
- Rental history

LEASE TERM

The lease term is 12 months.

PETS

No pets are permitted

MOVE IN

Upon commencement of the lease, you may pick up keys at our office or arrange for delivery of them by calling the number above. The first month's rent must be paid in full prior to the keys being released.